

Welcome

A message from the Club Chairman and Club Manager

We are both delighted to welcome you and your friends and family to Stratford Sports Club. We pride ourselves on the flexibility and versatility of the Club in meeting your requirements, be they business-related or social or sporting.



Please arrange to meet us and we will be delighted to show you around and ensure that our facilities can be tailored to your needs.

George Fisher - Chairman Sally Willes - Club Manager

Sports

We are host to seven different sports, each of which has its own Committee, fixtures and programme of social events. We



are particularly proud of the youth development schemes which are in operation within the Club, yet there is something for everybody here, be they a recreational player or an elite athlete.



The sports on offer are: Athletic, Boxing, Cricket, Hockey, Snooker, Squash and Tennis.



Please ask for a copy of the separate flier which explains the sporting provision in more detail.



What we can offer

- VERSATILE FACILITIES AND FLEXIBLE ACCOMMODATION
- SEATING FOR UP TO 150 DELEGATES
- PROJECTORS AND LAP-TOP CONNECTIVITY
- THREE SEPARATE SPACES
- COMPREHENSIVE BAR AND CATERING PROVISION
- WI-FI THROUGHOUT
- BEAUTIFUL SURROUNDINGS AND A SAFE AND SECURE ENVIRONMENT
- OVER 100 PARKING SPACES
- WHEELCHAIR ACCESS
- CENTRAL LOCATION WITHIN 5 MINUTES WALK OF THE CENTRE OF STRATFORD



Stratford Sports Club

We can cater for a wide variety of functions, including:

- Corporate Events*
- Wedding Receptions*
- Business Meetings*
- Birthday Parties*
- Presentations*

HOW TO FIND US

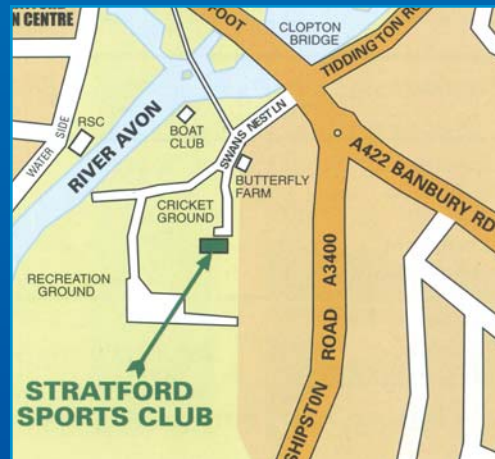

Stratford Sports Club
Swans Nest Lane, Stratford upon Avon CV37 7LS

Tel/Fax: 01789 296629
Email: admin@stratfordsportsclub.co.uk
www.stratfordsportsclub.co.uk

The Ideal Venue

Situated in beautiful surroundings, Stratford Sports Club occupies a ten acre site within a five minute stroll of Stratford town centre, its shops, theatres and the River Avon.

The recently refurbished clubhouse has ample parking and an attractive terrace overlooking Stratford's riverside cricket ground. It is equipped to provide flexible accommodation for a range of business meetings, including conferences, seminars and training courses for up to 150 delegates.

With first-class catering and a licensed bar, we can also accommodate business lunches, dinners, dances and other social functions.

So if you are looking for a top quality venue at an affordable price, you will find our facilities and charges hard to beat.



The Terrace Room

Overlooking the grounds with a view of the Shakespeare Theatre, this is the largest of the rooms and has the capacity to seat around 100 people for a Dinner or Wedding reception. This can be expanded by opening the doors onto the Patio which can be covered with a Marquee. It has its own bar and catering access. Fully equipped with 3 metre screen, HD projector and flat screen television, all of which can be used for presentations. We also have a comprehensive Sky TV package.

The Pavilion Room

This can be used as a separate room with its own bar or can be incorporated into the Terrace Room to increase its seating capacity - or to add a dance floor! This room is ideal for a small function such as a presentation, meeting or a training event and has a seating capacity of either 40 in theatre style or 30 around tables. The room also has a screen with equipment to hire.

The Committee Room

With a seating capacity of about 25 in theatre style or 15 around tables this is the "quiet room" of the club, ideal where concentration is important. Access to this room is via the Pavilion Room and be used in conjunction with the latter, also with a screen and equipment.



Versatile Facilities

	Terrace room	Pavilion room	Committee room
Dimensions	13 x 7m (91 sq m)	8 x 8m (64 sq m)	6 x 5m (30 sq m)
Capacities			
Seating style			
• Theatre	100	40	25
• Boardroom	90	30	15
• Dinner	90	30	15
Technical			
• 13A sockets	8	10	4
• TV points	1	1	1

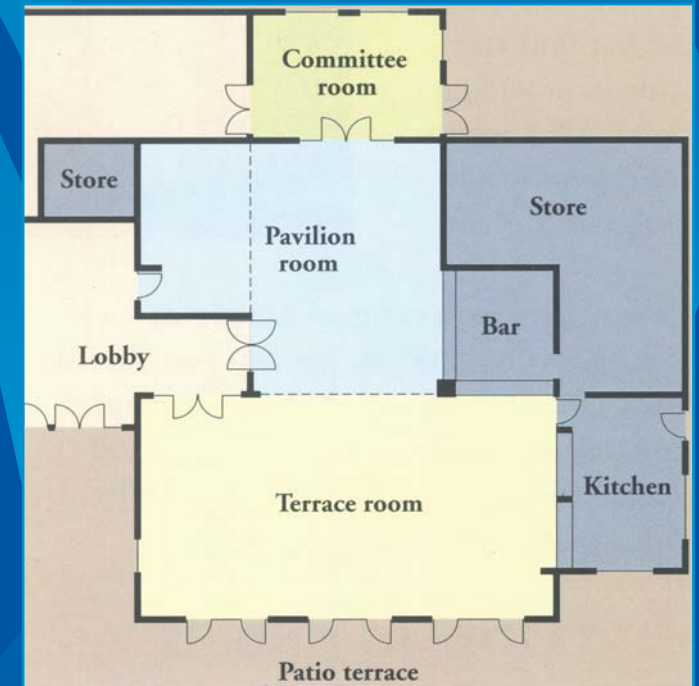

The clubhouse has three self-contained areas which can be utilised together in any combination. All the rooms have 13A sockets and TV points.

We also supply Office equipment which includes, Data Projector, TV and DVD or Video, Flipcharts, OHP, Screen, Pens and Wi-Fi access. All prices can be supplied with an enquiry or booking.